

Project Information

Reference Thermic Technology
 Date 9/3/17
 Client Timber Frame Solutions
 Tel: 01257 241084
 Email: info@thermictechnology.co.uk

This 4-page document contains:

- U-value calculation
- Condensation risk analysis
- CAD drawing of wall structure

Construction Type

Element : Wall - 140 - PhotonFrame - 0.040 - PhotonFoil - 0.16

Timber framed wall

Internal surface emissivity	: High	External surface emissivity	: High		
		Thickness (mm)	Thermal Conductivity (W/mK)	Thermal Resistance (m ² K/W)	Pitch Bridge details Air gaps (Level, Delta U")
Outside surface resistance	-	-	-	0.040	
Brick - outer leaf (BRE)		103.0	0.770	0.134	17.332% Mortar (103.0mm)
Cavity (Un-vented cavity - width=600.0mm, hro=5.100, E1=0.050, E2=0.900, horizontal heat flow)		50.0	-	0.665	
PhotonFrame		33.0	0.034	0.971	6.333% Compressed PhotonFrame and Timber (33.0mm)
OSB (BS5250)		9.0	0.130	0.069	L:0 0.000W/m ² K
Earthwool FrameTherm Roll 40		140.0	0.040	3.500	15.000% Prefabricated panels (140.0mm)
PhotonFoil		33.0	0.034	0.971	L:0 0.000W/m ² K 6.333% Compressed PhotonFoil and Timber (33.0mm)
50x38mm batten cavity (Bridged un-vented cavity - width=550.0mm, hro=5.100, E1=0.050, E2=0.900, horizontal heat flow)		23.0	-	0.665	6.333% Softwood (~500kg/m ³) (23.0mm)
Plasterboard (BS5250)		12.5	0.170	0.074	
Plaster, lightweight (BS5250)		3.0	0.220	0.014	
Inside surface resistance	-	-	-	0.130	

U-value = 0.16W/m²K

U-value, Combined Method : 0.157W/m²K (upper/lower limit 6.622 / 6.155m²K/W, dUf 0.0000, dUg 0.0000, dUp0.0000, dUr0.0000, dUrc1 0.0000, dUrc2 0.0000)

Correction factors

Air gaps, Delta Ug = 0.000W/m²K

(Based on the combined method for determining U-values of structures containing repeating thermal bridges)

	Thickness (mm)	Thermal Conductivity (W/mK)	Thermal Resistance (m ² K/W)	Vapour Resistivity (MNs/gm)	Vapour Resistance (MNs/g)
Outside surface resistance	-	-	0.040	-	-
Brick - outer leaf (BRE)	103.0	0.770	0.134	50.00	5.15
Cavity (Un-vented cavity - width=600.0mm, hro=5.100, E1=0.050, E2=0.900, horizontal heat flow)	50.0	-	0.665	-	0.26
PhotonFrame	33.0	0.034	0.971	0.00	0.22
OSB (BS5250)	9.0	0.130	0.069	500.00	4.50
Earthwool FrameTherm Roll 40	140.0	0.040	3.500	5.00	0.70
PhotonFoil	33.0	0.034	0.971	-	192.00
50x38mm batten cavity (Bridged un-vented cavity - width=550.0mm, hro=5.100, E1=0.050, E2=0.900, horizontal heat flow)	23.0	-	0.665	-	0.13
Plasterboard (BS5250)	12.5	0.170	0.074	60.00	0.75
Plaster, lightweight (BS5250)	3.0	0.220	0.014	30.00	0.09
Inside surface resistance	-	-	0.130	-	-

Condensation Risk Analysis (no account taken of thermal bridges)

3 - Dwellings with low occupancy

Jan (worst)	Feb	Mar	Apr	May	Jun	Jul	Aug	Sep	Oct	Nov	Dec
20.0C 48.8%	20.0C 48.9%	20.0C 50.7%	20.0C 52.9%	20.6C 56.3%	22.1C 59.2%	22.9C 60.8%	22.9C 60.7%	21.8C 58.5%	20.3C 55.6%	20.0C 51.3%	20.0C 49.5%
3.8C 83.0%	3.9C 81.0%	5.7C 76.5%	7.9C 74.0%	11.3C 71.5%	14.2C 73.5%	15.8C 75.5%	15.7C 76.5%	13.5C 78.5%	10.6C 81.0%	6.3C 82.5%	4.5C 83.5%

	Interface Temp. °C	Dewpoint Temp. °C	Vapour Pressure (kPa)	Saturated V.P. (kPa)	Worst Cond. (g/m ²)	Peak Buildup (g/m ²)	Condensation
1 Outside surface resistance							
2 Brick - outer leaf (BRE)	3.9	1.2	0.67	0.81			No
3 Cavity	4.2	1.4	0.68	0.82			No
4 PhotonFrame	5.7	1.4	0.68	0.91			No
5 OSB (BS5250)	7.9	1.5	0.68	1.06			No
6 Earthwool FrameTherm Roll 40	8.0	1.7	0.69	1.07			No
7 PhotonFoil	15.8	1.7	0.69	1.80			No
8 50x38mm batten cavity	18.0	8.9	1.14	2.07			No
9 Plasterboard (BS5250)	19.5	8.9	1.14	2.27			No
10 Plaster, lightweight (BS5250)	19.7	8.9	1.14	2.29			No
11 Inside surface resistance	19.7	8.9	1.14	2.30			No

Worst case internal / external conditions for graph : 20.0°C @ 48.8%RH / 3.8°C @ 83.0%RH

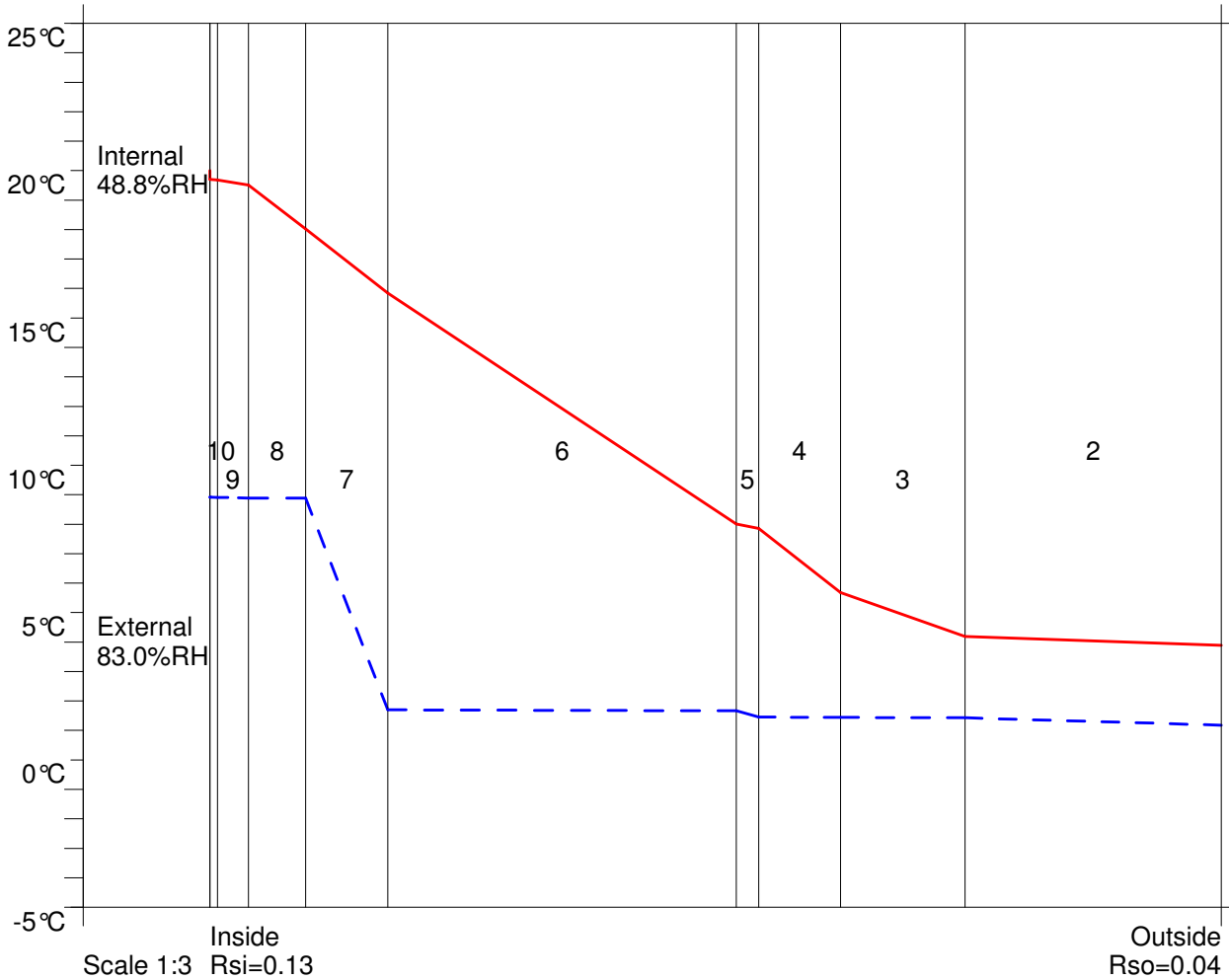

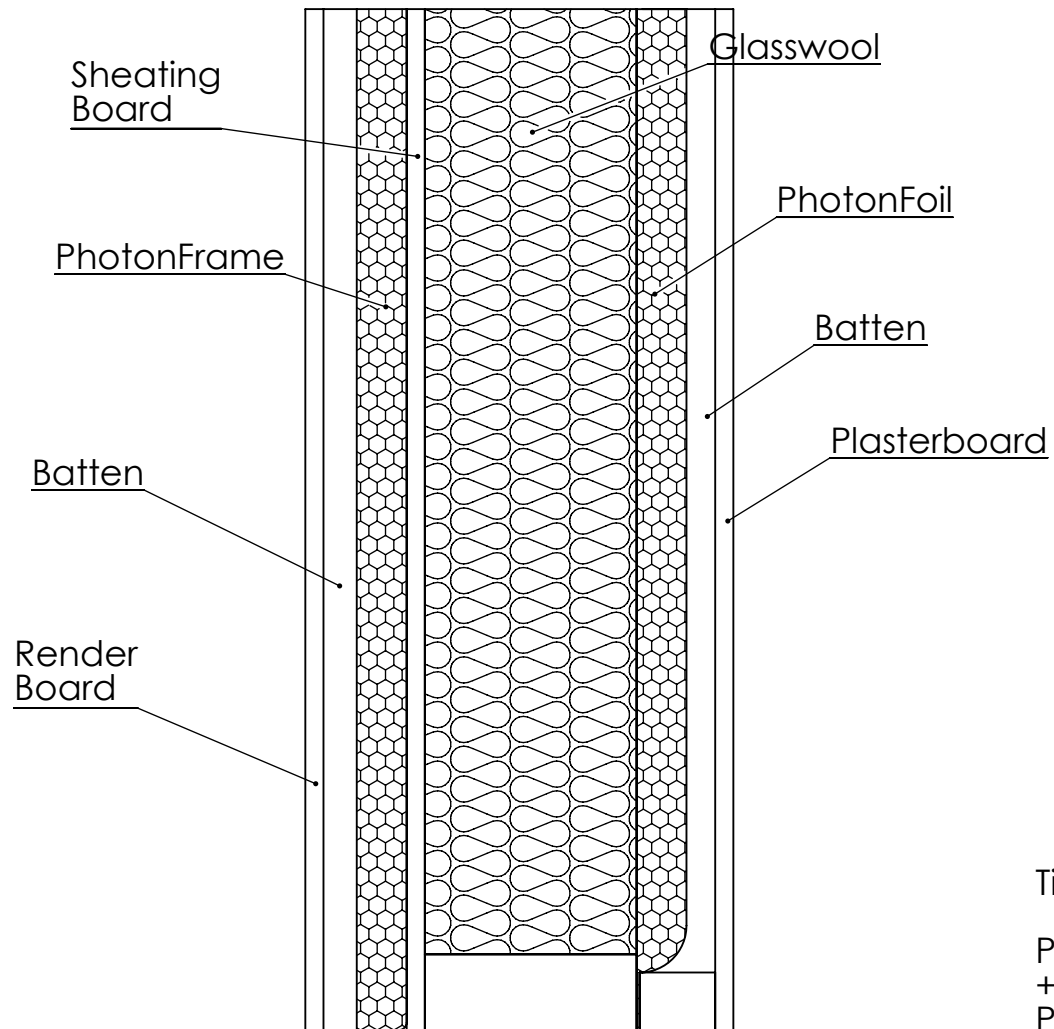

Timber Frame

PhotonFoil
+
PhotonFrame
+
RenderBoard

2D CAD

October 2107